

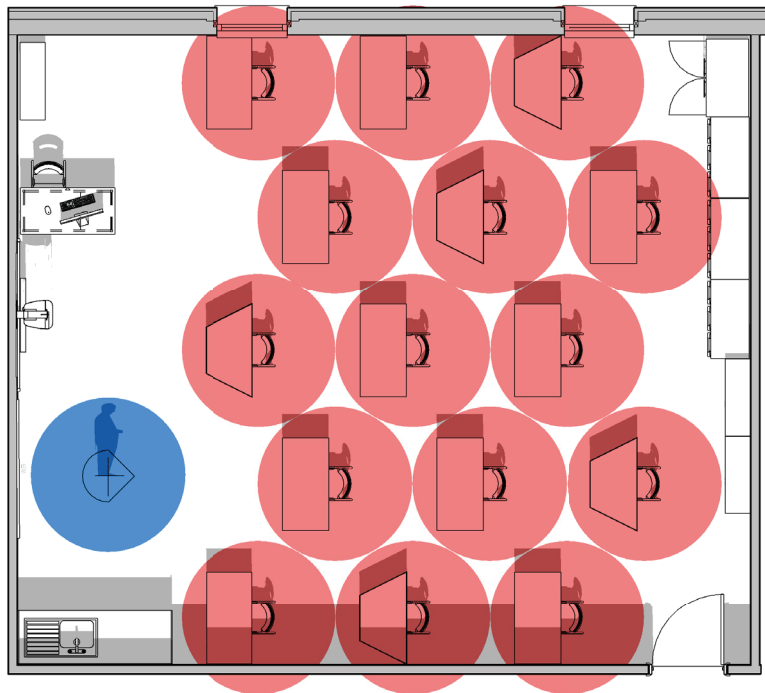

Adapting the Classroom - 15 Pupils

Where distancing for the 15 pupils can be achieved, consider this plan.

Adaption



-  **1m Distance space - Pupils**
(per individual to meet 2m guidance).
-  **1m Distance space - Teacher**
(per individual to meet 2m guidance).

Original

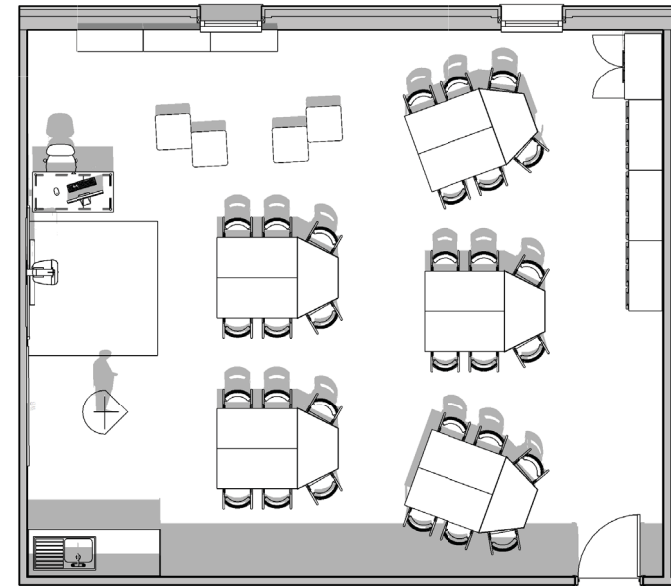

Suggestions:

- Remove soft furnishings: soft seating, rugs, teachers' operator chair etc.
- Move storage to fit around the desk space once safe distance is achieved.
- Where a sink is available allow for hand washing breaks, especially when entering and leaving the room.
- Make the most of the existing desking to create the space.